

# BURNERS



# ALL THERM

OIL, GAS AND DUAL: UP TO 5M KCAL/H  
THIRD WORLDWIDE INDUSTRIAL GROUP  
TUV INTERNATIONAL CERTIFICACION

**2 YEAR GUARANTY**

**PGN 2 A**  
**PGN 2**  
**PGN 2 SP**



**Burner Performance Chart**

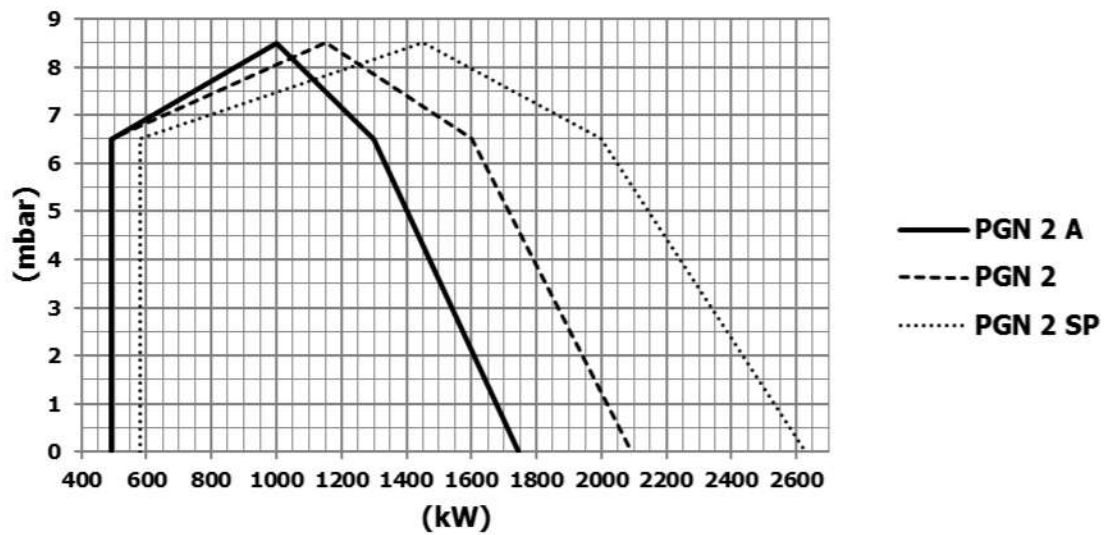

	Function	Fuel	Gas Pressure mbar	Gas Consumption m <sup>3</sup> n/h	Heating Capacity kW
<b>PGN 2 A</b>	Two Stage	Natural Gas	40-80	52-183	493-1744
<b>PGN 2</b>	Two Stage	Natural Gas	40-80	52-220	493-2093
<b>PGN 2 SP</b>	Two Stage	Natural Gas	40-80	61-276	528-2628

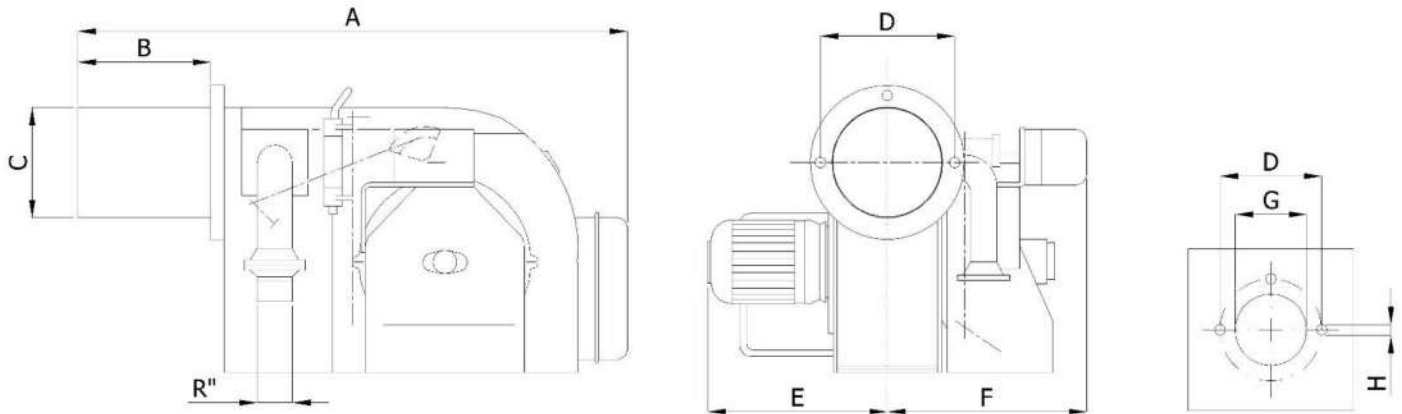
**Burner Dimensions**

	A	B	C	D	E	F	G	H	R''
<b>PGN 2 A</b>	960	220	194	305	390	390	200	M12	2
<b>PGN 2</b>	960	220	194	305	420	390	200	M12	2
<b>PGN 2 SP</b>	960	220	219	305	420	390	225	M12	2 ½

<b>Burner Equipment</b>	<b>PGN 2 A</b>	<b>PGN 2</b>	<b>PGN 2 SP</b>
Fan Motor	3 ~ 2.2 kW	3 ~ 3 kW	3 ~ 4 kW
Servomotor	Conectron LKS 310	Conectron LKS 310	Conectron LKS 310
Control Unit	Satronic TMG 740	Satronic TMG 740	Satronic TMG 740
Ignition Transformer	Brahma TB2S Electronic / 2×12 kV / 35 mA	Brahma TB2S Electronic / 2×12 kV / 35 mA	Brahma TB2S Electronic / 2×12 kV / 35 mA
Gas Solenoid Valve (Fast Opening)	Dungs 2"	Dungs 2"	Dungs 2 ½"
Gas Solenoid Valve (Slow Opening)	Dungs 2"	Dungs 2"	Dungs 2 ½"
Gas Pressure Control	Gas pressure switch Dungs or Krom Schroder	Gas pressure switch Dungs or Krom Schroder	Gas pressure switch Dungs or Krom Schroder
Air Pressure Control	Air pressure switch Dungs or Krom Schroder	Air pressure switch Dungs or Krom Schroder	Air pressure switch Dungs or Krom Schroder
Flame Detector	Ionizing electrode	Ionizing electrode	Ionizing electrode
Burner Control Panel	✓ (Separated)	✓ (Separated)	✓ (Separated)



## ALL THERM (GIBRALTAR) LTD

### HEADQUARTERS :

World Trade Center  
6 Bayside Road 1st Floor - Unit 1.02  
GX1 1AA Gibraltar  
☎ (+350) 200 60207  
✉ info@alltherm.group

### SALES MANAGER :

Javier *Martinez* Lesmes  
C/ López Bravo 7. Naves CAM 45  
09001 Burgos  
☎ (+34) 639 324 269  
✉ j.martinez@alltherm.group

